



£900

Belsize Close, Worthing

- REDECORATED ONE BEDROOM FLAT
- OWN PRIVATE FRONT DOOR
- OFF STREET PARKING
- NEUTRAL DECOR
- FANTASTIC LOCATION
- GROUND FLOOR
- SEPARATE FITTED KITCHEN
- DOUBLE GLAZED WINDOWS
- FITTED WARDROBES
- VIEWING ESSENTIAL

ROBERT LUFF & CO are delighted to offer to let a delightful recently refurbished one bedroom ground floor flat located on secluded mews style development in central Worthing on BELSIZE CLOSE.

Comprising OWN PRIVATE ENTRANCE FRONT DOOR, entrance hall, double bedroom with fitted wardrobes, lounge, separate fitted kitchen and fitted bathroom suite.

OPEN DAY 8TH OF MARCH BETWEEN 12:00 - 13:30

ALLOCATED OFF STREET PARKING

VIEWING ESSENTIAL.

T: 01903 331247 E: info@robertluff.co.uk
www.robertluff.co.uk

**Robert
Luff & Co**
 Sales | Lettings | Commercial



Accommodation



Floor Plan
Approx. 42.5 sq. metres (457.5 sq. feet)

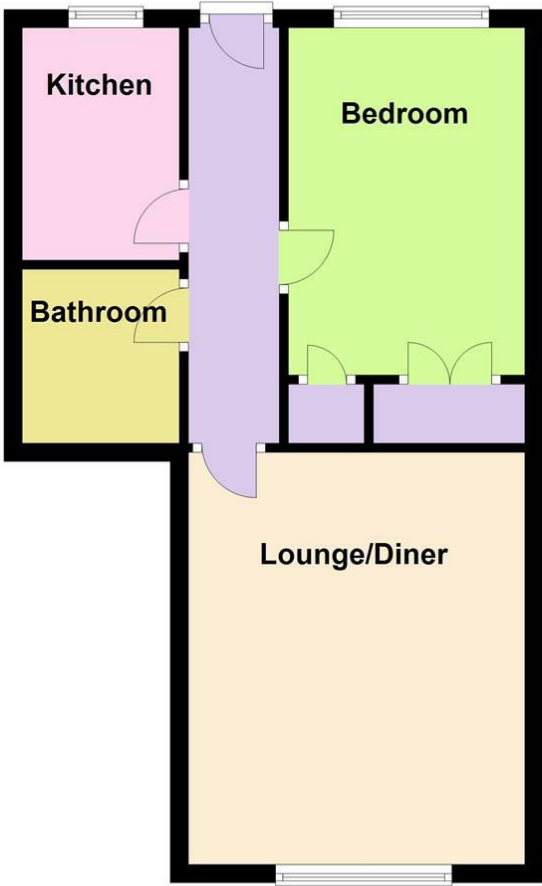

Total area: approx. 42.5 sq. metres (457.5 sq. feet)

Energy Efficiency Rating		Environmental Impact (CO ₂) Rating			
	Current	Potential		Current	Potential
Very energy efficient - lower running costs				Very environmentally friendly - lower CO2 emissions	
(92 plus) A				(92 plus) A	
(81-91) B				(81-91) B	
(69-80) C				(69-80) C	
(55-68) D				(55-68) D	
(39-54) E				(39-54) E	
(21-38) F				(21-38) F	
(1-20) G				(1-20) G	
Not energy efficient - higher running costs				Not environmentally friendly - higher CO2 emissions	
England & Wales		EU Directive 2002/91/EC		England & Wales	

The information provided about this property does not constitute or form any part of an offer or contract, nor may it be regarded as representations. All interested parties must verify accuracy and your solicitor must verify tenure/lease information, fixtures and fittings and, where the property has been extended/converted, planning/building regulation consents. All dimensions are approximate and quoted for guidance only as are floor plans which are not to scale and their accuracy cannot be confirmed. References to appliances and/or services does not imply that they are necessarily in working order or fit for the purpose.